

1996 Somerset Houseboat



- 16x60 Widebody S/S 615 Sq. Ft.
- Twin 115 HP Mercury Four Stroke EFI O/B (2004 or newer)
- 290 Gallon Aluminum Fuel Tanks
- Dual MMC Electronic Shift & Throttle Controls
- 12.5 Westerbeke Generator (Gas)
- Halon Fire Suppression System (in generator compartment)
- Fly Bridge
- Roof Top Canopy
- Roof Top Barsink/Fridge Combo
- Fiberglass Storage Boxes
- Water Slide
- 3 Ton Central Air/Heat
- 4 Bedrooms/2 Baths
- Sleeper Sofa
- Dinette Sleeper Sofa
- Full Size Electric Refrigerator
- Full Size Electric Range/Oven
- Built in Microwave
- Cooking Pots and Utensils
- Gas BBQ Grill
- TV/DVD/Stereo/VHF Radio
- CO2 Detectors
- 160 Gallon Potable Water Holding Tank
- 480 Gallon Grey Water Holding Tank
- 160 Gallon Black Water Holding Tank
- 17 Gallon Electric Hot Water Heater
- Gang Plank
- 2 Anchors/Ropes
- Lifejackets

\$89,500.00

Call BOO BOO @ (337)278-0243

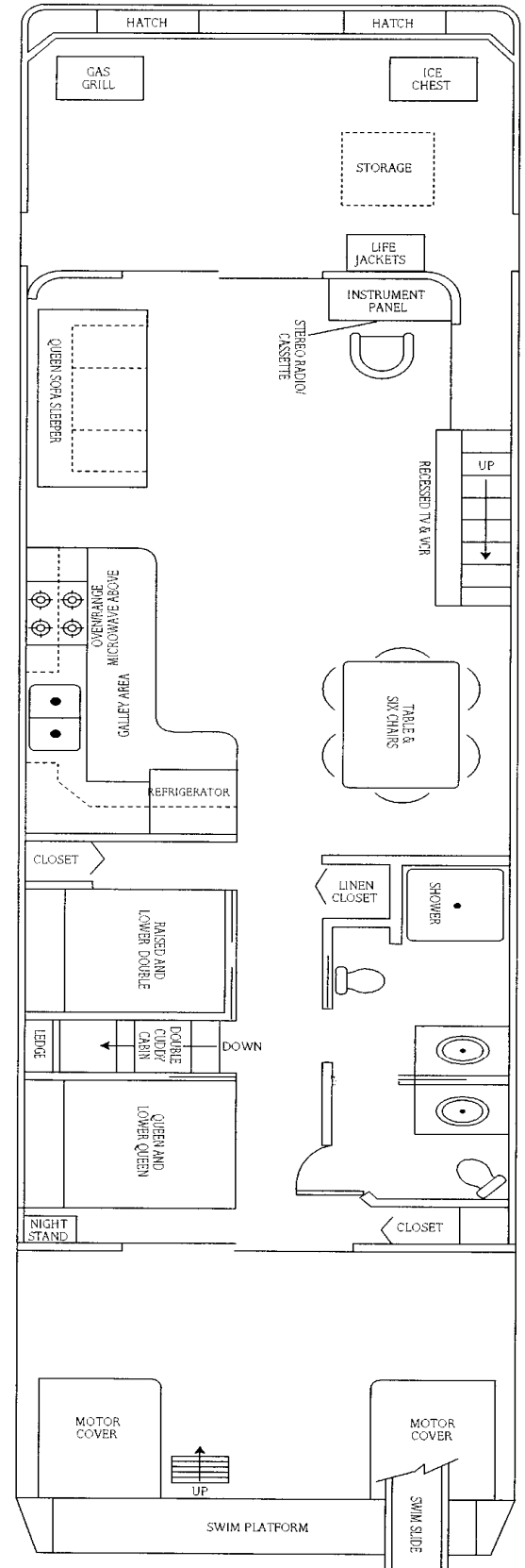

Registration #: UT2645KA

Location: Port of West St. Mary, La